

Light Hex,  
Thin Height

# NYLON INSERT (ELASTIC) STOP NUTS

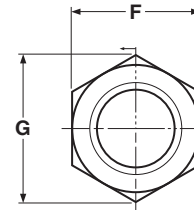
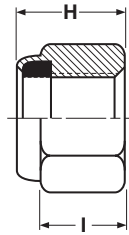

NYLON INSERT STOP NUTS, LIGHT HEX, THIN HEIGHT											Esna®
Nominal Size or Basic Thread Diameter		Esna® Part Numbers		F			H		I	G	
		Steel, Zinc-plated		Width Across Flats			Thickness		Side Height	Width Across Corners	
		Coarse	Fine	Basic	Max	Min	Max	Min	Ref	Ref	
2	0.0860	21NTM-26	--	1/4	0.251	0.243	0.124	0.094	0.075	0.268	
4	0.1120	21NTM-40	--	1/4	0.251	0.243	0.124	0.094	0.075	0.268	
6	0.1380	21NTM-62	--	5/16	0.313	0.305	0.140	0.110	0.090	0.339	
8	0.1640	21NTM-82	--	11/32	0.345	0.336	0.187	0.157	0.110	0.374	
10	0.1900	21NTM-04	21NTM-02	3/8	0.376	0.367	0.187	0.157	0.110	0.410	
12	0.2160	21NTM-124	--	7/16	0.439	0.430	0.218	0.188	0.125	0.482	
1/4	0.2500	21NTE-040	21NTE-048	7/16	0.439	0.430	0.218	0.188	0.125	0.482	
5/16	0.3125	21NTE-058	21NTE-054	1/2	0.502	0.492	0.265	0.235	0.158	0.552	
3/8	0.3750	21NTE-066	21NTE-064	9/16	0.564	0.553	0.281	0.251	0.150	0.622	
7/16	0.4375	21NTE-074	21NTE-070	5/8	0.627	0.615	0.328	0.298	0.225	0.694	
1/2	0.5000	21NTE-083	21NTE-080	3/4	0.752	0.741	0.328	0.298	0.190	0.837	
9/16	0.5625	--	21NTE-098	7/8	0.877	0.865	0.374	0.344	0.225	0.978	
5/8	0.6250	21NTE-101	21NTE-108	15/16	0.940	0.928	0.406	0.376	0.265	1.051	
3/4	0.7500	41NTE-120	41NTE-126	1-1/8	1.064	1.052	0.421	0.391	0.288	1.191	
7/8	0.8750	41NTE-144	--	1-1/4	1.252	1.239	0.484	0.454	0.340	1.403	
1	1.0000	41NTE-164	--	1-7/16	1.440	1.427	0.578	0.516	0.405	1.615	
1 1/4	1.2500	41NTE-202		1-13/16	1.815	1.801	0.765	0.703	0.523	2.038	

<b>Description</b>	Identical to a standard pattern nylon-insert stop nut but not as thick from top to bottom.	
<b>Applications/ Advantages</b>	Same general applications as the standard pattern, but thin pattern nuts are used when an insufficient number of projecting threads are present to use a standard nylon insert nut.	
<b>Material</b>	<i>Steel</i> #4 through 5/8" diameters: AISI 1008 - 1010 or equivalent steel. 3/4" diameter & larger: AISI C1117 or equivalent steel.	<i>Stainless</i> 18-8: Type 303 or equivalent stainless steel
<b>Hardness</b>	Rockwell C 28 maximum	1/4 through 5/8": Rockwell B95 - C32; 3/4 through 1-1/2": Rockwell B80 - C32
<b>Proof Load</b>	Thin pattern nylon insert nuts are intended for use in limited clearance applications and not for load bearing purposes. If a precise engineering standard is required, parts should be laboratory tested.	
<b>Plating</b>	Steel nylon insert stop nuts are usually supplied with a zinc plating.	Stainless nylon insert stop nuts are usually provided without any additional plating.

Esna® is a registered trademark of the MacLean-Fogg Company. Kanebridge's stop nuts are not manufactured by or connected with the producers of Esna® nuts.